

NO	변경 사항	수정 내용	비고	수정	일시	승인	일시
1	3개소 형상 변경	변경점 통보서에 의거		2012.05.08	2012.05.08	C.W.D	2012.05.09
2							
3							

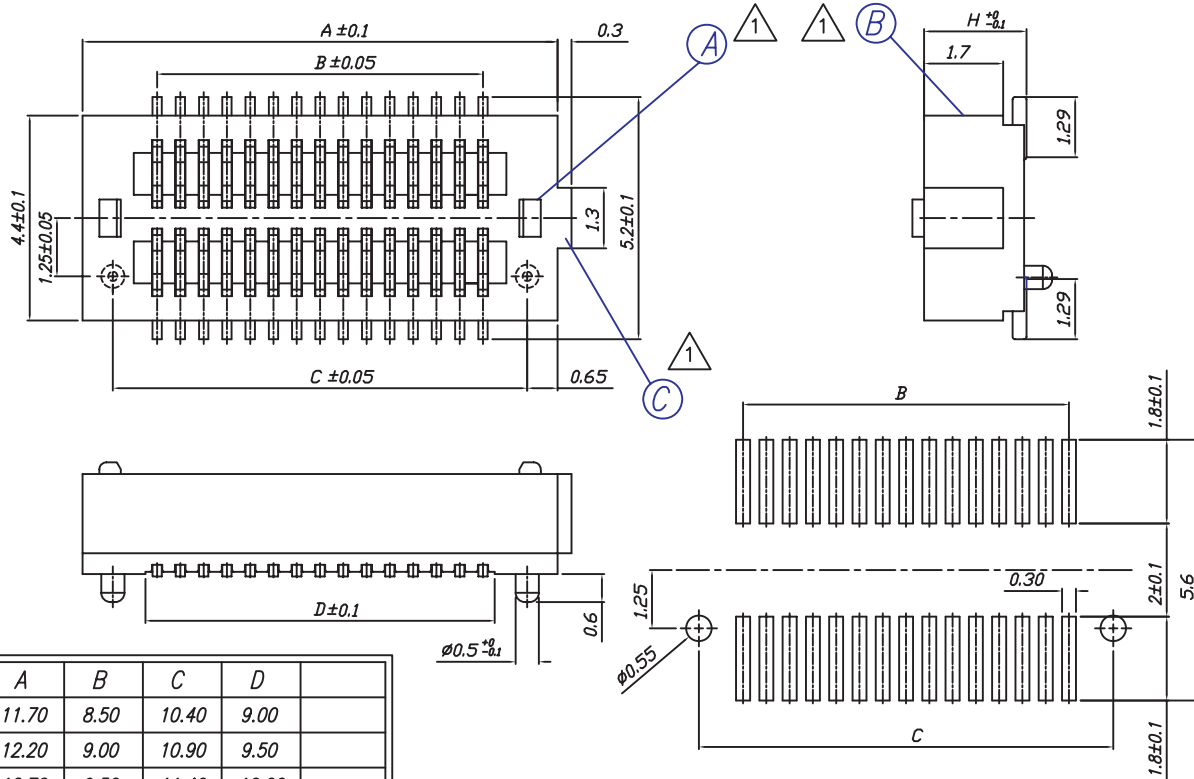

HIGH	SOCKET(H)	PLUG(H)
3.0	2.2	0.8
3.5	2.2	1.3
4.0	3.0	1.0
4.5	3.5	1.0
5.0	4.0	1.0
5.5	4.5	1.0
6.0	4.0	2.0
6.5	4.5	2.0

	A	B	C	D		A	B	C	D	
08P	4.70	1.50	3.40	2.00		36P	11.70	8.50	10.40	9.00
10P	5.20	2.00	3.90	2.50		38P	12.20	9.00	10.90	9.50
12P	5.70	2.50	4.40	3.00		40P	12.70	9.50	11.40	10.00
14P	6.20	3.00	4.90	3.50		42P	13.20	10.00	11.90	10.50
16P	6.70	3.50	5.40	4.00		44P	13.70	10.50	12.40	11.00
18P	7.20	4.00	5.90	4.50		46P	14.20	11.00	12.90	11.50
20P	7.70	4.50	6.40	5.00		48P	14.70	11.50	13.40	12.00
22P	8.20	5.00	6.90	5.50		50P	15.20	12.00	13.90	12.50
24P	8.70	5.50	7.40	6.00		60P	17.70	14.50	16.40	15.00
26P	9.20	6.00	7.90	6.50		70P	20.20	17.00	18.90	17.50
28P	9.70	6.50	8.40	7.00		80P	22.70	19.50	21.40	20.00
30P	10.20	7.00	8.90	7.50		90P	25.20	22.00	23.90	22.50
32P	10.70	7.50	9.40	8.00		100P	27.70	24.50	26.40	25.00
34P	11.20	8.00	9.90	8.50						

P.C.B PATTEN

Min:0.03 $\mu$ m Gold plating over Min:1.2 $\mu$ m Nickel

DRAWG NO	PART NAME	MATERIAL	QUANTITY	SPECIFICATION	TREATMENT	REFERENCE
	SOCKET	PA 6T		CS210R-SH : #0.2(phosphor bronze)		
		THROUGH HOLE PROJECTION	UNIT mm	SCALE	TOLERANCE	
		APPROVAL	CHECK	DESIGN	DRAW	
MARK	DATE	REVISION	SIGN			
					WK NAME	NO.5mm SOCKET-LK
					PART NAME	0.5mm BOARD TO BOARD
					DRAWG NO.	



NO	변경 사항	수정 내용	비고	수정	일시	승인	일시
1	2개소 형상 변경	변경점 통보서에 의거		2012.05.08	2012.05.08	C.W.D	2012.05.09
2							
3							

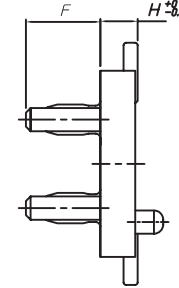
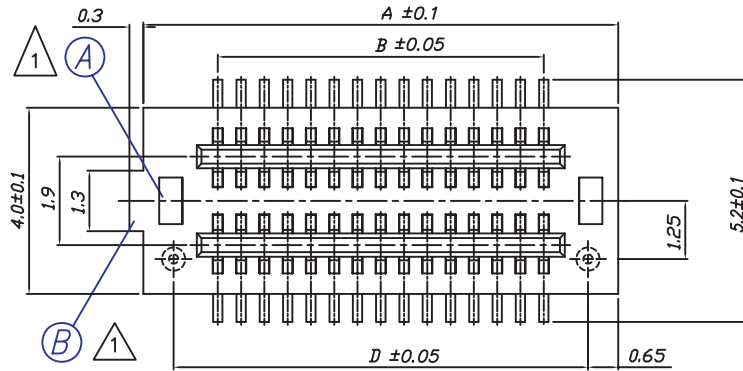

HIGH	PLUG	SOCKET	F
3.0	0.8	2.2	1.6
3.5	1.3	2.2	1.6
4.0	1.0	3.0	1.9
4.5	1.0	3.5	1.9
5.0	1.0	4.0	1.9
5.5	1.0	4.5	1.9
6.0	2.0	4.0	1.9
6.5	2.0	4.5	1.9

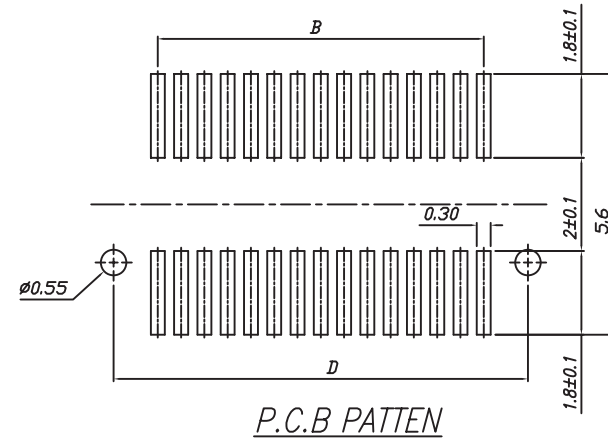
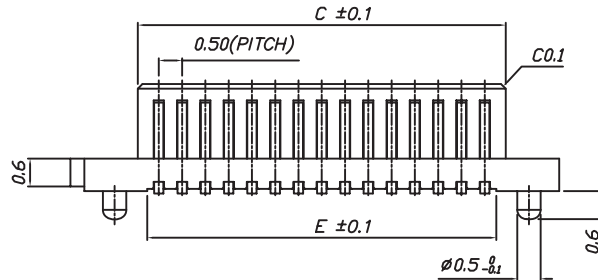

	A	B	C	D	E		A	B	C	D	E
10P	5.20	2.00	2.90	3.90	2.50	36P	11.70	8.50	9.40	10.40	9.00
12P	5.70	2.50	3.40	4.40	3.00	38P	12.20	9.00	9.90	10.90	9.50
14P	6.20	3.00	3.90	4.90	3.50	40P	12.70	9.50	10.40	11.40	10.00
16P	6.70	3.50	4.40	5.40	4.00	42P	13.20	10.00	10.90	11.90	10.50
18P	7.20	4.00	4.90	5.90	4.50	44P	13.70	10.50	11.40	12.40	11.00
20P	7.70	4.50	5.40	6.40	5.00	46P	14.20	11.00	11.90	12.90	11.50
22P	8.20	5.00	5.90	6.90	5.50	48P	14.70	11.50	12.40	13.40	12.00
24P	8.70	5.50	6.40	7.40	6.00	50P	15.20	12.00	12.90	13.90	12.50
26P	9.20	6.00	6.90	7.90	6.50	60P	17.70	14.50	15.50	16.40	15.00
28P	9.70	6.50	7.40	8.40	7.00	70P	20.20	17.00	18.00	18.90	17.50
30P	10.20	7.00	7.90	8.90	7.50	80P	22.70	19.50	20.50	21.40	20.00
32P	10.70	7.50	8.40	9.40	8.00	90P	25.20	22.00	23.00	23.90	22.50
34P	11.20	8.00	8.90	9.90	8.50	100P	27.70	24.50	25.50	26.40	25.00

Min:0.03 $\mu$ m Gold plating over Min:1.2 $\mu$ m Nickel

DRAWG NO		PLUG	PA 6T	CS210R-SH : 10.2(phosphor bronze)		TREATMENT	REFERENCE		
PART NAME		MATERIAL	QUANTITY	SPECIFICATION					
THROUGHLE PROJECTION	UNIT mm	SCALE	TOLERANCE		WK NAME	NO.5mm PLUG-LK			
APPROVAL	CHECK	DESIGN	DRAW					PART NAME	0.5mm BOARD TO BOARD
MARK	DATE	REVISION	SIGN					DRAWG NO.	